

## Plastic square shape capacitive sensors **CE35** series



### Features

- ◆ Be able to detect both metal and nonmetal objects;
- ◆ Be able to detect various media via nonmetallic container;
- ◆ Reliable liquid level detecting;

### Part number

NPN NO	CE35SF10DNO	CE35SN15DNO	PNP NO	CE35SF10DPO	CE35SN15DPO
NPN NC	CE35SF10DNC	CE35SN15DNC	PNP NC	CE35SF10DPC	CE35SN15DPC

### Technical specifications

Mounting	Flush	Non-flush	Consumption current	≤15mA
Rated distance [Sn]	10mm (adjustable)	15mm(adjustable)	Circuit protection	Reverse polarity protection
Assured distance [Sa]	0...8mm	0...12mm	Output indicator	Yellow LED
Dimensions	35*50*15mm		Ambient temperature	-10°C...55°C
Output	NO/NC(depends on part number)		Ambient humidity	35-95%RH
Supply voltage	10...30 VDC		Switching frequency [F]	50 Hz
Standard target	Fe35*35*1t	Fe45*45*1t	Voltage withstand	1000V/AC 50/60Hz 60S
Switch-point drifts [%/Sr]	±20%		Insulation resistance	≥50MΩ (500VDC)
Hysteresis range [%/Sr]	3...20%		Vibration resistance	10...50Hz (1.5mm)
Repeat accuracy [R]	≤3%		Degree of protection	IP67
Load current	≤200mA		Housing material	PBT
Residual voltage	≤2.5V		Connection type	2m PVC cable

### Dimensions

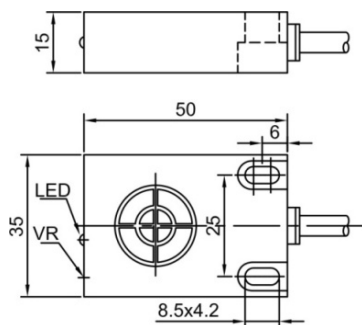

### Wiring diagram

